

## Integrated Building Management System

**B01700-00**

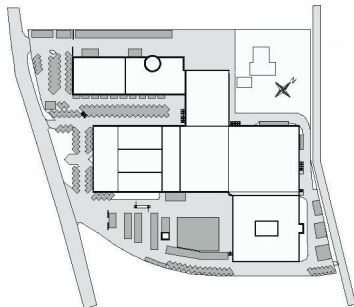

### Description

#### **WinGuard basic software for Windows XP/2000/2003 Server**

Integrated Building Management System to control and organize all kind of messages of several security systems. Using a Windows PC this software provides full control and indication of all events display on one or two PC screens. All message / events are saved in history memory. The open structure philosophy provides flexible organisation of users, events and control action by just one system. Windows compatible drawings are used to localize alarm, fault and other messages inside the building.

This system provides in basic configuration the interface for the NSC „Solution F1“ fire detection system and it can be upgraded by other interface like CCTV interfaces or intruder alarm interfaces.

- One user licence (Network licence as an option)
- 300 Data points included (zones / detectors / system messages)
- Data points can be extended in steps by 100 (code no. B01715-00)
- 3 default user profiles (User, main user, administrator)
- Basic graphics editor to import wmf, bmp and jpg files
- Event memory for all kind of messages
- Printer interface included
- Internal buzzer in case of alarm, fault etc.
- Incl. Interface to FCP „Solution F1“
- Other interfaces and Dual-Screen-Operation as an option
- Upgrade to „WinGuard Standard“ possible

**B01715-00**

#### **Set of further 100 data points**

Extension of basis WinGuard software by further 100 Data points - Data Point = Detector, module, zone, input, output

**B01722-00**

### Description

#### WinGuard - Data Point editing

Creating / editing of one data point for the **basic drawings**.

Positioning and configuration of the data point incl. link to the "Solution F1" protocol.

**B01725-00**

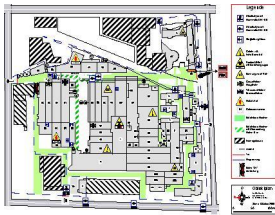

#### WinGuard – Editing of one new drawing

For the representation in WinGuard the diagram is provided individually after, from the client to supplying, collecting submittals.

**B01727-00**

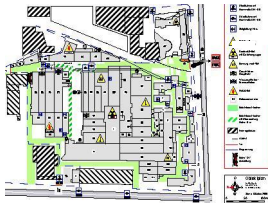

#### WinGuard – Import of one drawing

After the import of an existing basic diagram this is optimized for the representation in WinGuard.

**B01740-00**

#### WinGuard - Editing of a messages text page

For important messages such as common alarm, system disturbance or fire brigade alerting. These texts can be accessed with all messages.

**B01745-00**

#### WinGuard Software Installation

Installation and testing of WinGuard software on the final computer

<b>B01750-00</b>	<p><b>Description</b></p> <p><b>Network extension</b></p> <p>Uniquely necessary in the network for the employment of additional control positions. Note: Required Windows network with TCP/IP protocol.</p>
<b>B01755-00</b>	<p><b>Software module for Dual-Screen-Operation</b></p> <p>Configuration option for the representation of individual system elements on two monitors (e.g.. Diagram and measure window, etc.)</p>
<b>B01760-00</b>	<p><b>Licence for additional work station (PC)</b></p> <p>A further control position license within a network installation (no further Dongle necessarily); needed for every further PC;</p>
<b>B01765-00</b>	<p><b>Additional interfaces for NSC products like Dedicated Micros, Intruder Alarm Panel etc.</b></p> <p>Interface module with interface-specific functions. Binding to further devices of the NSC product range.</p>
<b>B01770-00</b>	<p><b>WinGuard Import Module dxf and dwg</b></p> <p>Import software module for files in dxf or dwg format.</p>

All WinGuard items do not include any hardware.